

# Sistemas de Habilitación

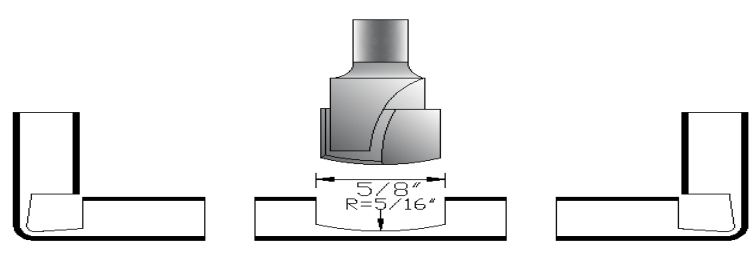
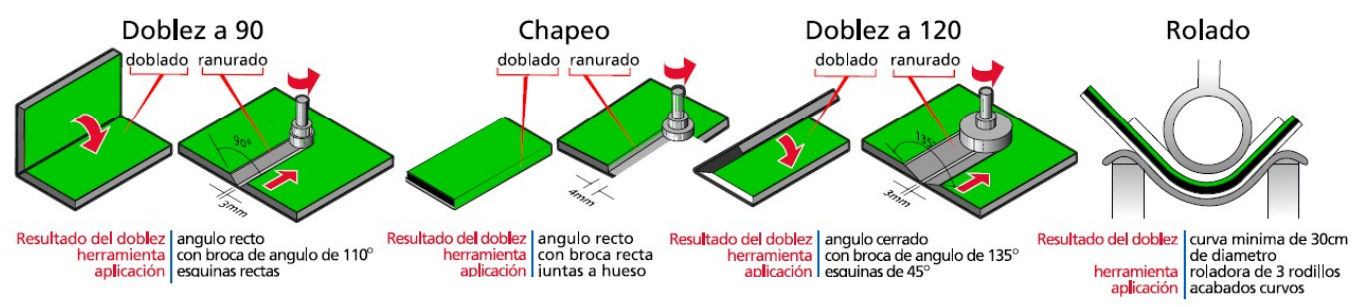

Herramienta para rauteo y doblez con paneles con capas de aluminio menos de 0.30mm de grosor

## Herramientas

Sierra circular manual

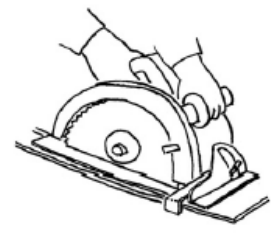

Sierra de mesa

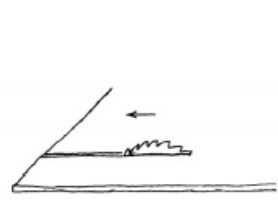

Fresadora manual

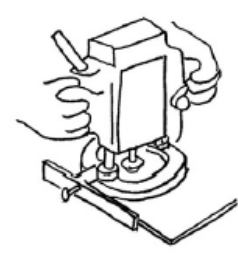

Torneador

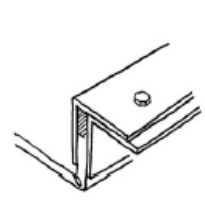

Sierra de panel

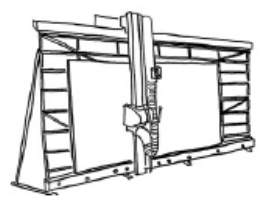

Cizalla cuadrada



Fresadora CNC

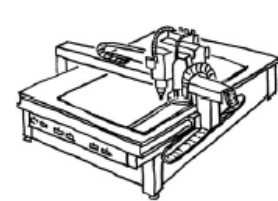

Plegador de 3 rodillos

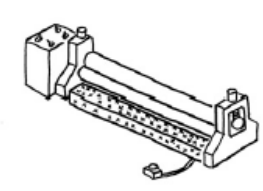

# Sistema de Fijación

## SISTEMA CON SELLO HERMETICO

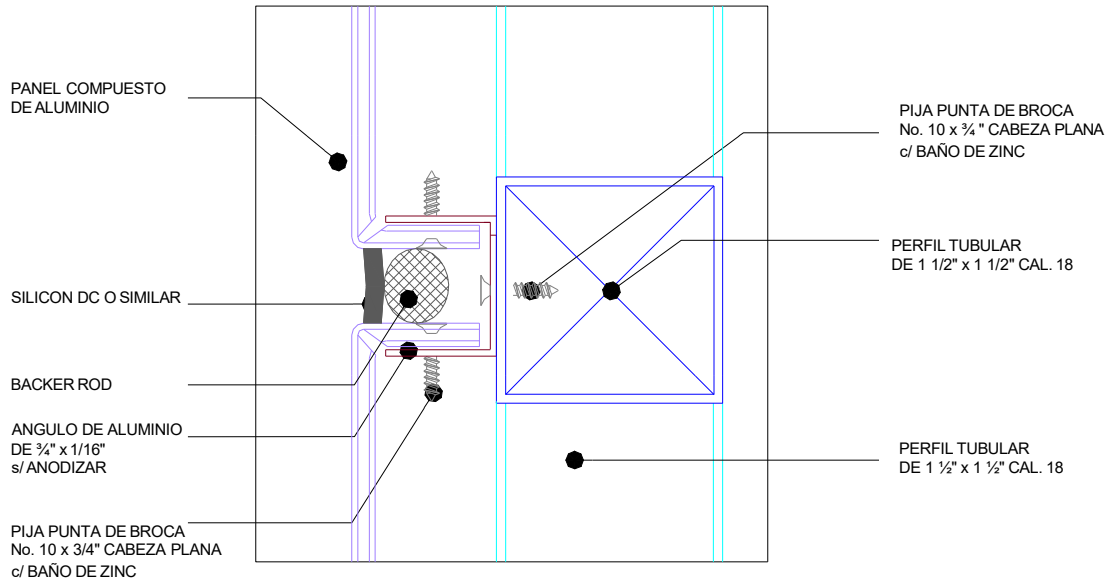

## SISTEMA CON CHAPEADO

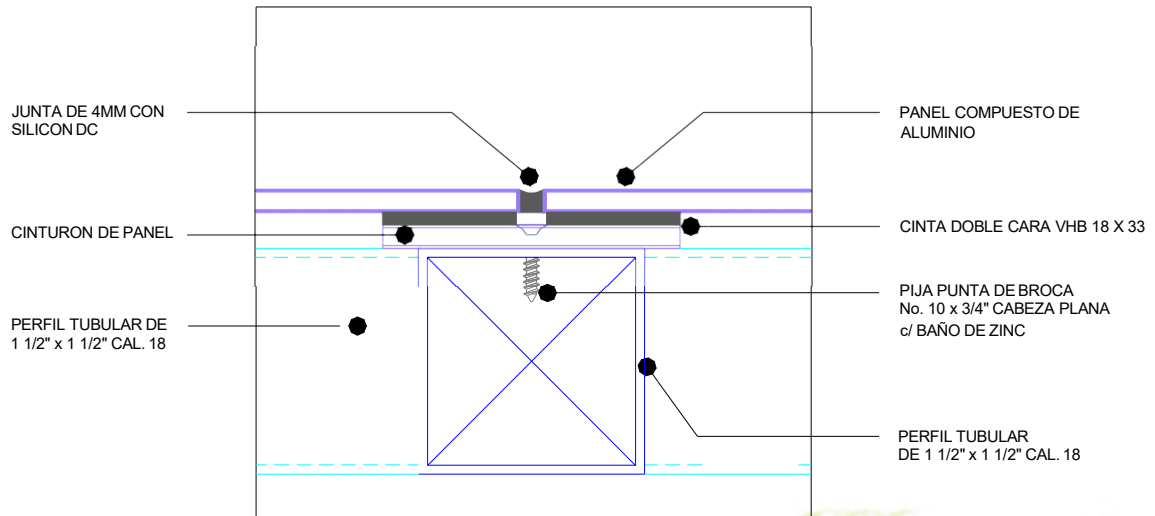

# Sistemas de Fijación

## SISTEMA PROGRESIVO CON JUNTA SECA

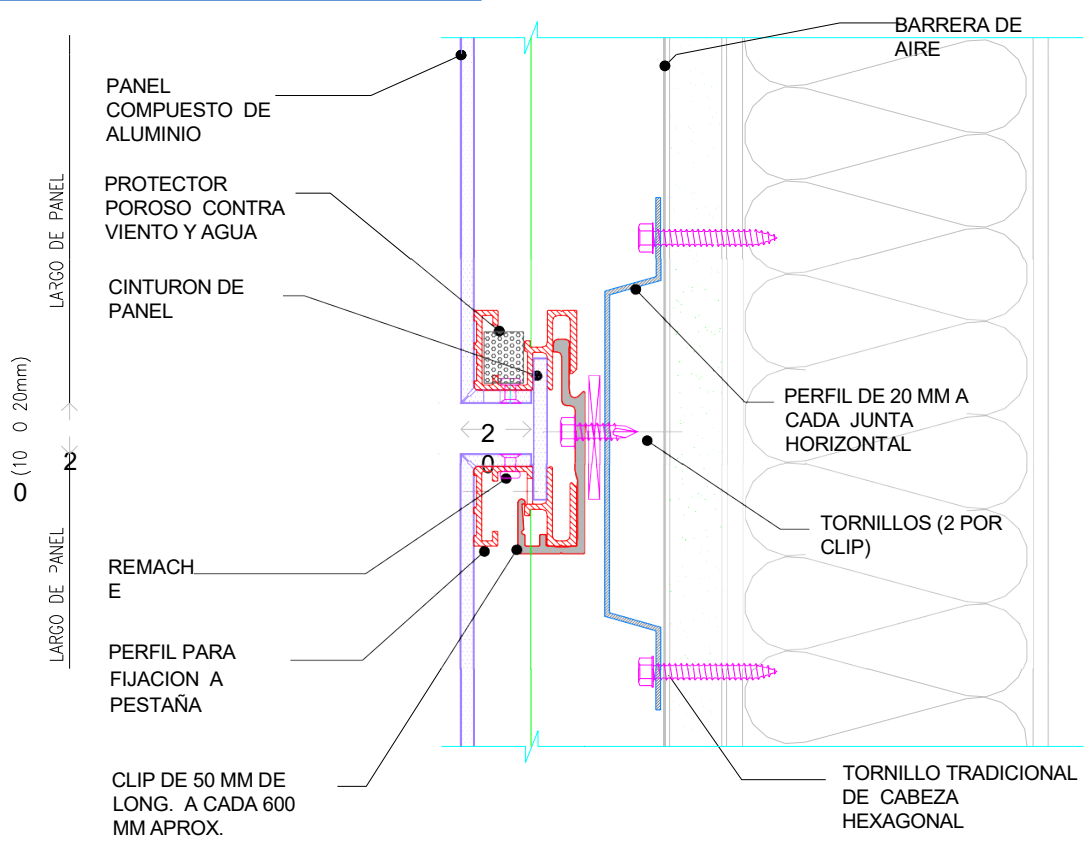

## SISTEMA PROGRESIVO CON JUNTA SELLADA

